

MDS Room and partition wall systems – the optimal solution for every space requirement



FLEXIBLE ROOM SYSTEMS



Workshop/Foreman's Offices



Partition Wall Systems



Glass Partition Walls



Structural Steel Platforms

Advice, production, delivery and assembly at fixed prices and fixed deadlines from one provider. Full service at the highest level.

Our top priority is a cooperative partnership with our customers, based on mutual trust. We shall do everything in our power to satisfy your demands. Our well-coordinated team of highly qualified and motivated employees will be pleased to help you!

Our services at a glance:



Competent advice and service



Our specialist advisors plan for you on site



Extensive range of products



Free CAD planning service



Advanced production facilities with highest quality demands



Professional installation of the components for all the technological areas by one supplier



Short construction time and turnkey handover on the agreed date



High economic efficiency and fixed price guarantee



FLEXIBLE ROOMS FOR PRODUCTION AND ADMINISTRATION 4

SHB 50 - Workshop Office System	6
STW 80 - Partition Wall System	10
PTW 82 - Partition Wall for Office and Administration	14

STRUCTURAL STEEL PLATFORM SYSTEM 18

SBB - Structural Steel Platform	20
---------------------------------	----

Accessories	24
-------------	----

Planning examples	26
-------------------	----

YOUR CONTACT

Andreas Tlustek
Sales Manager
Phone: +49 7733 9489-43
Mobile Phone: +49 172 7383767
Email: a.tlustek@mds-raumsysteme.com



Carbon neutral
Print product
ClimatePartner.com/12518-1907-1001





Individual room concepts –
turnkey handover

Workshop/Foreman's Offices and Partition Wall Systems

Rationalization, optimization and control of the production flow are becoming more and more important. We plan the best possible room solution for you and supply you with the rooms necessary. Reliable and fast – from small foreman's offices to 2-storey, large-scale facilities.



SHB 50 – Workshop Office System

»As the Production Manager I have to be available for my colleagues at any time and keep an overview; nevertheless, I also need a quiet place to work when I need to concentrate. Both are optimally possible with our new MDS Workshop Office System.«

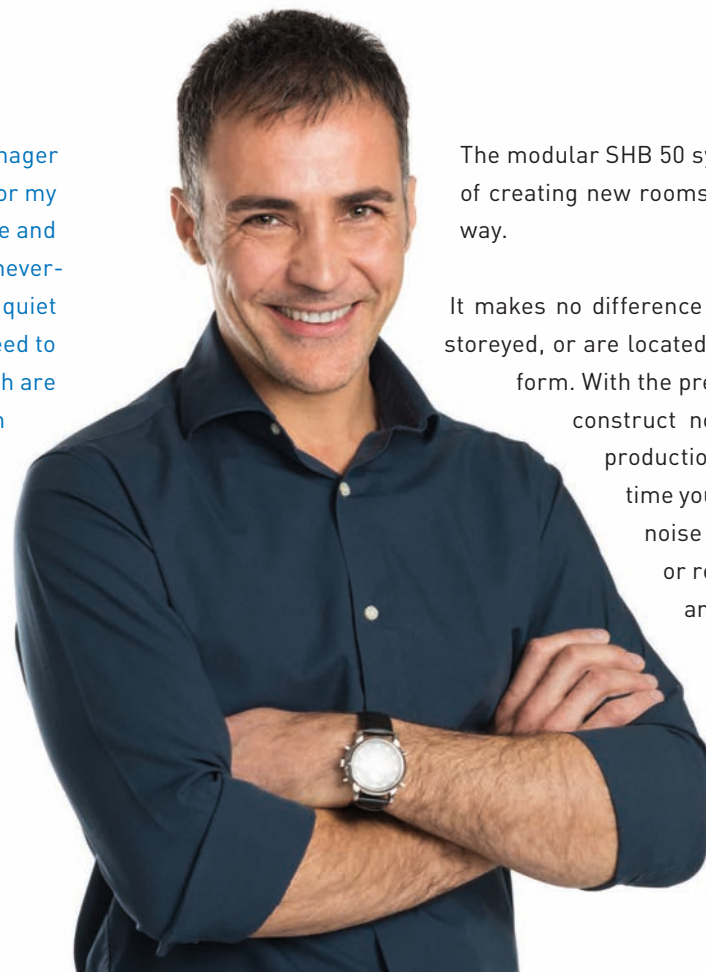

The modular SHB 50 system offers you the ideal possibility of creating new rooms in a fast, flexible and cost-efficient way.

It makes no difference whether the new rooms are 1 or 2 storeyed, or are located on or under a structural steel platform. With the prefabricated elements it is possible to construct noise-reduced zones in storage and production areas. In the shortest possible time you will have an office away from all the noise and dust. Subsequent modifications or relocations can be performed without any problem – fast and free of dirt and dust.

An intelligent system with many advantages:

- Optimum protection from noise and dust
- Maximum view
- Effective room utilization
- Modern design
- Highest quality demands
- Turnkey construction
- Extensibility without any problem
- Mobility at a reasonable price



2-storey room solution



Room solution on a platform



Movable room solution (maximum size 6 × 3 m)

Standard Floor

- Total height: 60 mm
- Surrounding tube frame (H = 60 mm) with inserted, longitudinal bars (H = 20 mm) and 2 chipboards V 100 (each 19 mm thick) installed with tongue and groove joint
- PVC floor covering (2 mm thick and finished)
- Option: Needle felt floor covering, false floor, floor insulation (20 mm)

Portable Floor

(Portable with forklift / max. size 6 x 3 m)

- Total height: 100 mm
- Surrounding tube frame (H = 100 mm) with welded-in cross and longitudinal bars and 2 chipboards V 100 (each 19 mm thick)
- PVC floor covering (2 mm thick and finished)

Wall Elements

- Prefabricated mono-block elements (53 mm thick), surrounding aluminium frame, powder-coated, melamine resin laminated chipboards on both sides (16 mm thick, scratch, impact and abrasion-resistant and extremely easy to clean)
- Option: Coated steel sheet plating (1 mm thick)
- Mineral fibre insulation lining (20 mm thick)
- Glazing with 1 x 5 mm float glass or 2 x 5 mm float glass respectively, for the ISO version, including PVC edge profiles and PVC cover strips for the connections
- Option: Toughened safety glass/laminated glazing
- Wall thickness: 53 mm
- Grid size: 1,000 mm

Choice of Colours

Profiles



Anthracite grey (RAL 7016)



Light grey (RAL 7035)



Gentian blue (RAL 5010)



Anodized aluminium

Wall surface



Anthracite grey (RAL 7016)

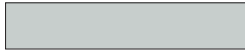

Light grey (RAL 7035)



Pure white (RAL 9010)

Other RAL colours on request

Door Elements

- Powder-coated aluminium door frame including rubber seal, chipboard tubular core (40 mm thick, clearance width 885 mm), including mortise lock, prepared for profile cylinder provided by the customer, handle set with rounded keyhole and 2 pcs nickel-plated screw-in hinges
- Option: Glass window with toughened safety glass (5 mm or 8 mm thick)
- Option: Schall-Ex® (retractable bottom seal)

Ceiling Element

- Suspended acoustic ceiling with inserted white mineral fibre panels (15 mm thick), design Harmony, size 625 x 625 mm, including white support construction and wide span supports
- chipboard covering (19 mm thick), accessible ceiling construction
- Option: Mineral wool insulation (40 mm thick)

Sound Insulation Values

- Rw = approx. 28 dB (A) standard version (only in connection with mineral wool insulation and chipboard panel installed on the ceiling)
- Rw = approx. 34 dB (A) ISO version

Construction

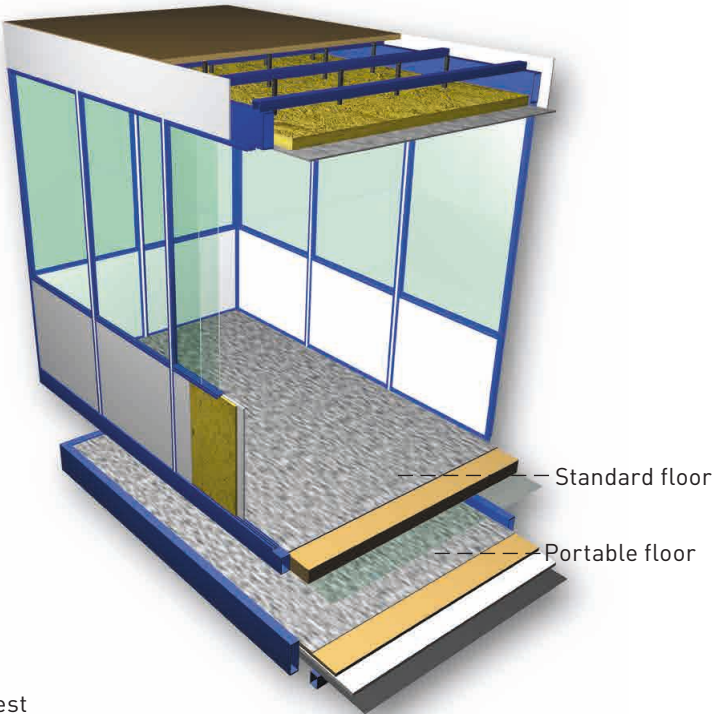

Solid wall

Width 500 mm
1,000 mm
Height 2,500 mm
2,750 mm
3,000 mm



Solid wall fitting element

Width up to 1,000 mm
Height 2,500 mm
2,750 mm
3,000 mm



Glass wall

Width 500 mm
1,000 mm
Height 2,500 mm
2,750 mm
3,000 mm



Fanlight wall

Width 500 mm
1,000 mm
Height 2,500 mm
2,750 mm
3,000 mm



Solid wall with sliding window

Width 1,000 mm
Height 2,500 mm
2,750 mm
3,000 mm



Door element

Width 1,000 mm
Height 2,500 mm



Door element with glass window

Width 1,000 mm
Height 2,500 mm



Double-wing door element



Double-wing door element with glass window



Sliding door element



Sliding door element with glass window

Other sizes and structural elements on request



STW 80 – Partition Wall System

»As the Quality Assurance Manager I am responsible for achieving the best possible processing of our products. Our new room systems have progressively facilitated and improved the work of our team.«

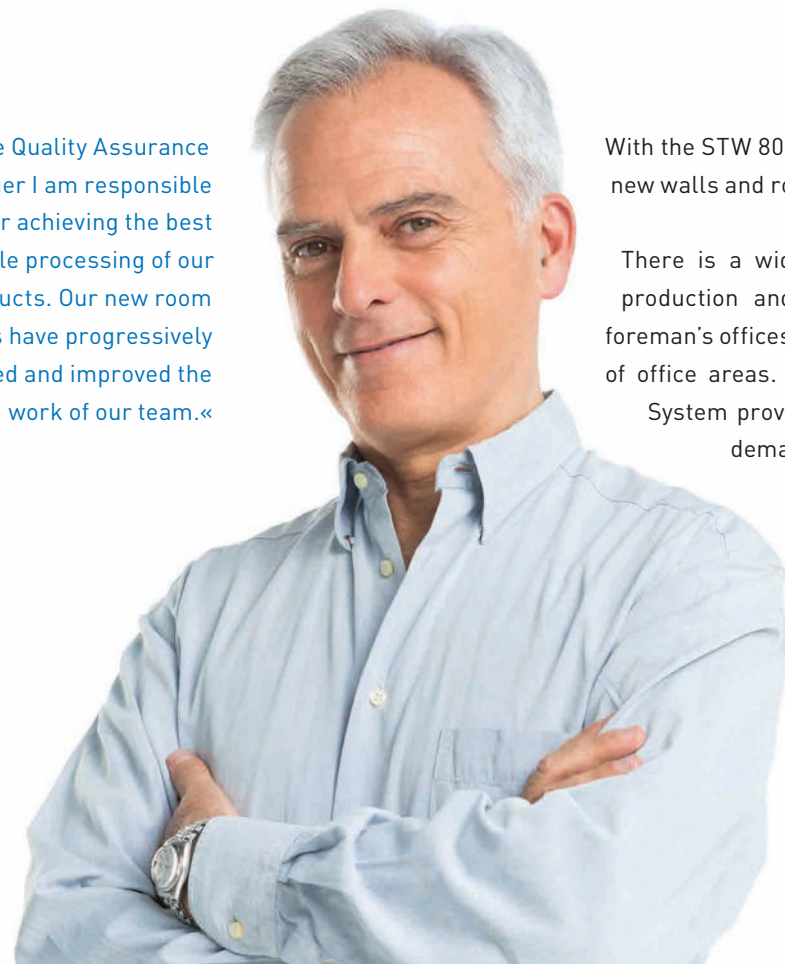

With the STW 80 Partition Wall System you efficiently create new walls and rooms quickly and free of dust.

There is a wide range of applications - for separating production and storage areas, creating workshop and foreman's offices, insulation of noise sources or sub-division of office areas. The intelligent and flexible Partition Wall System provides the suitable solution for almost every demand.

In combination with a modern floor and ceiling system and an extensive range of accessories, we offer you the complete, cost-effective solution from one provider.

An intelligent system with many advantages:

- Simple, clean and fast installation
- Complete, robust surfaces without any painting work
- Permanent flexibility
- Turnkey design from one provider
- Optimal sound insulation
- High-level efficiency



2-storey room solution



Room solution on a platform



Partition walls for clean rooms

Wall Construction

- Displaceable, flexible partition wall system with galvanized steel framework (50 mm thick), wall panelling with melamine resin laminated chipboards on both sides (16 mm thick)
- Acoustic lining made of 40 mm thick mineral fibre insulation panels, cover profiles made of aluminium top-hat sections and PVC cover strips
- Floor connection with skirting board
- Wall thickness: 82 mm
- Grid size: 1,200 mm

Glass Elements

- Surrounding aluminium frame (82 mm thick), powder-coated, PVC edge profiles and double glazing, flush with the surface, with 2 x 5 mm float glass
- Standard dimensions: 1,200 mm x 1,085 mm (W x H) or 600 mm x 1,085 mm (W x H)
- Standard sill height: 1,050 mm
- Option: Toughened safety glass/laminated glazing

Door Elements

- Closed version consisting of: two-shell steel frame with rebate, primed and painted in RAL colour, with hollow chamber profile on 3 sides
- Door with chipboard tubular core 40 mm thick with standard rebate, insert made of tubular chipboard and laminated covering on both sides, including mortise lock, prepared for profile cylinder provided by the customer, handle set with rounded keyhole and 2 pcs nickel-plated screw-in hinges, frame clearance dimension: 936 x 2,093 mm (W x H)
- Option: Glass window, double-wing door, all-glass door, Schall-Ex® (retractable bottom seal), swing door, roller doors, fast-action doors

Standard Floor

- Total height: 60 mm
- Surrounding tubular frame (H = 60 mm) with inserted longitudinal bars (H = 20 mm) and 2 chipboards V 100 (each 19 mm thick) installed with tongue and groove joint
- PVC floor covering (2 mm thick and finished)
- Option: Needle felt floor, false floor, floor insulation (20 mm)

Ceiling Element

- Suspended acoustic ceiling with inserted white mineral fibre panels (15 mm thick), design Harmony, size 625 x 625 mm, including white supporting construction and wide span supports
- chipboard covering (19 mm thick), accessible ceiling construction
- Option: Mineral wool insulation (40 mm thick)

Sound Insulation Values

- Rw = approx. 43 dB (A) solid wall with mineral wool
- Rw = approx. 40 dB (A) solid wall without mineral wool
- Rw = approx. 36 dB (A) glass element

Construction



Choice of Colours

Profiles



Anthracite grey (RAL 7016)



Light grey (RAL 7035)

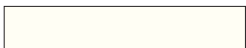

Pure white (RAL 9010)

Other RAL colours on request

Wall surface



Anthracite grey (RAL 7016)



Light grey (RAL 7035)



Pure white (RAL 9010)

Door frame



according to RAL

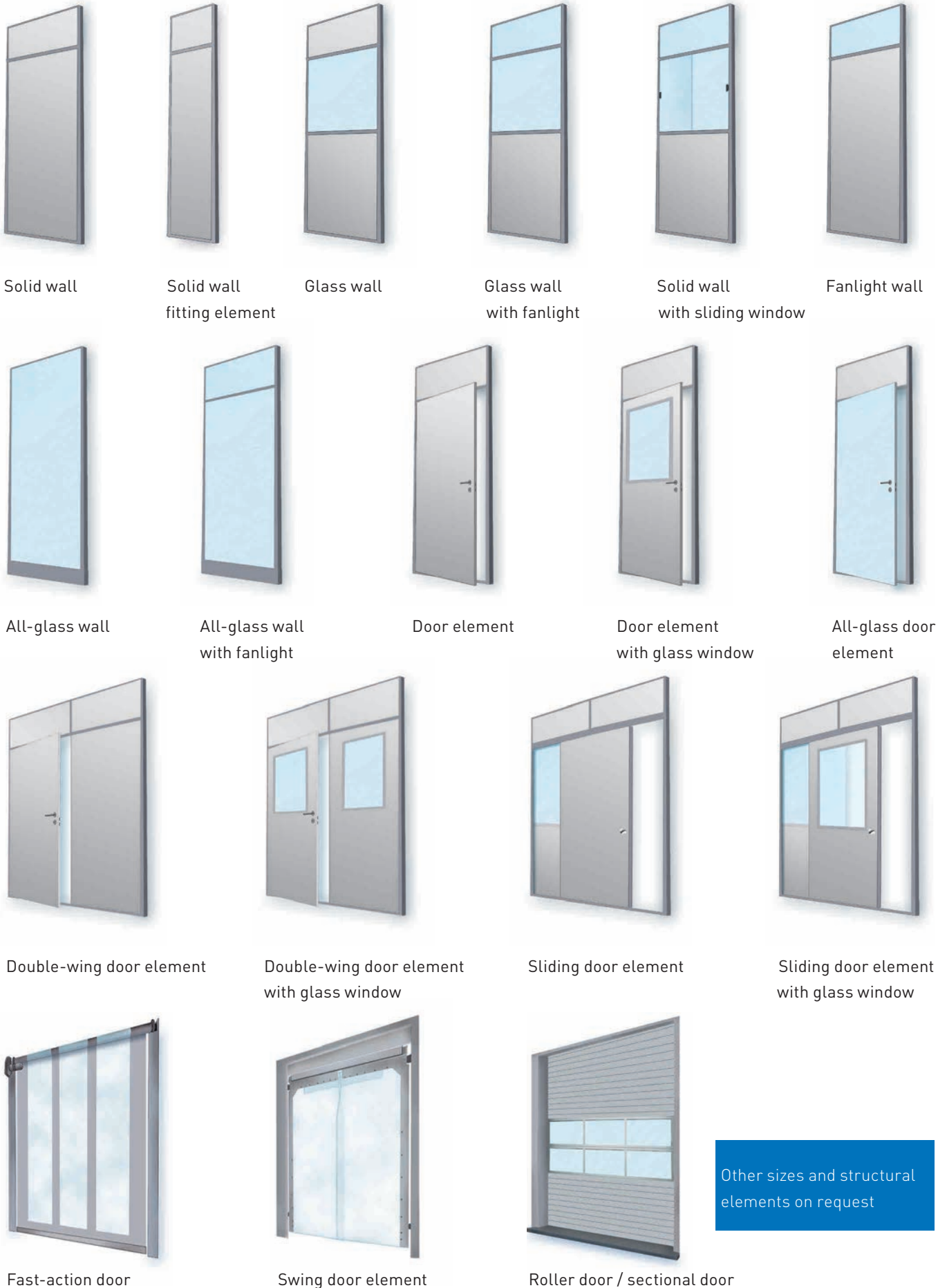

Other sizes and structural elements on request



PTW 82 – Partition Wall for Office and Administration

An intelligent system with many advantages:

»Our office rooms need to be flexible, i.e. a conference room one day, and a workplace or a seminar room the next. And we have found that the Office Room Systems also have this flexibility.«



The PTW 82 Partition Wall System offers countless options for creating new rooms in your existing office and administration areas – fast, flexible and visually appealing.

The variable planning of layout and surface, as well as the unlimited possibilities for combining solid wall surfaces with glass surfaces enable individual design.

The partition wall is available with PVC cover profiles and PVC skirting boards or, alternatively, with steel skirting boards, painted top-hat profile and keder strip.

The fixture of the single elements using top-hat profiles allows short reconstruction times and adjustments to be made directly at the construction site.

- Shorter construction time thanks to a high degree of prefabrication
- Simple realisation and convertibility
- High efficiency with respect to modification
- Installations and modifications without noise and dirt
- Hard and durable partition wall surface
- Sustainability due to reusability and recyclability
- Wide range of surface materials, structures and colours
- High sound insulation value



Partition wall as a room-dividing element



Executive office with double glazing



Particular transparency using glass partition walls

Wall Construction

- Wall thickness: 82 mm
- Galvanized substructure 56 mm thick with horizontal reinforcements, system perforations in the supports for routing cables and pipes
- Floor profile with plastic base as a standard, with steel base as a variant
- Panelling with 2 x 13 mm melamine resin laminated chipboards, alternatively powder-coated sheet steel or Taurid coating on gypsum-board carrier plates; special solutions on request
- Cover profiles, galvanized top-hat sections with PVC cover plates or powder-coated variant profiles with keder strips

Glass Elements

- | | |
|------------------------|-------------------------|
| ■ Steel frame | powder-coated |
| ■ Standard sill height | 900 mm |
| ■ Double glazing | 4 and 6 mm float glass |
| ■ Single glazing | 6 mm float glass |
| ■ Other glass types | available as a standard |

Door Elements

- Rebated doors and un-rebated door leaves
- Thickness depending on the required sound absorption class with laminated covering on both sides
- Surface according to sample template
- All-glass doors with toughened clear glass or satin-finished surfaces
- Double door systems
- Special door systems on request
- Option: Glass window, Schall-Ex® (retractable bottom seal)

Sound Insulation Values

- Solid wall $R_{w,P}$ = approx. 36 – 46 dB
- Glass wall $R_{w,P}$ = approx. 21 – 40 dB
- Doors up to sound protection class SSK 2

Manifold Surface Variants

- Melamine resin laminated chipboards, monochrome or deco finishing, according to your choice
- Various types of glass
- Steel panels made of powder-coated sheet steel with gypsum-board carrier plate
- Taurid coated surfaces with gypsum-board carrier plates

Construction

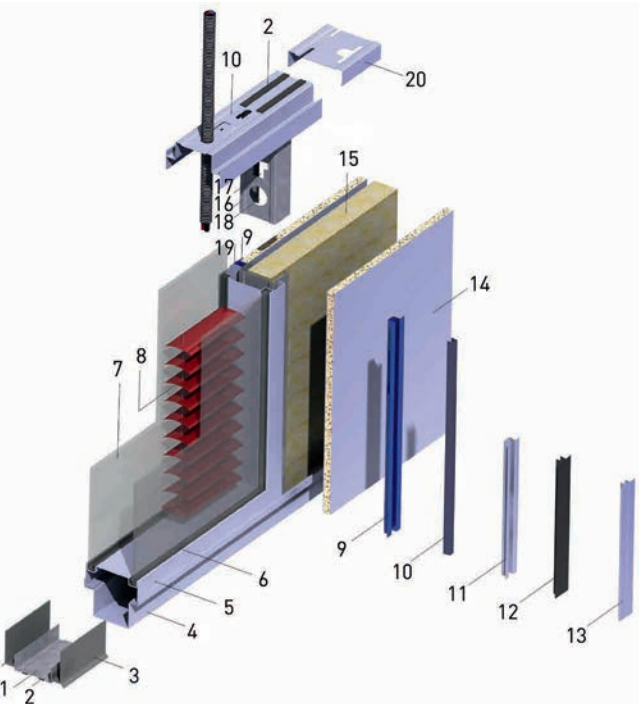

1. Galvanized floor profile
2. Sealing tape
3. Plastic base board
4. Floor profile with shadow gap
5. Glass element
6. Transparent glass holder made of plastic
7. Glazing
8. Interior blinds between the double glazing
9. Top-hat profiles of powder painted steel
10. Filling profile of plastic
11. Top-hat profile of galvanized steel
12. Cover profile of plastic
13. Cover profile of powder painted steel
14. Melamine laminated chipboard
15. Mineral wool
16. Steel support
17. Perforation for the cross profiles
18. Perforation for the cable duct
19. Ceiling profile with shadow gap
20. Wall profile / Ceiling profile



Solid wall



Solid wall fitting element



Glass wall



Glass wall with fanlight



Solid wall with sliding window



Fanlight wall



All-glass wall



All-glass wall with fanlight



Door element



Door element with glass window



All-glass door element



Double-wing door element



Double-wing door element with glass window



Sliding door element



Sliding door element with glass window

Other sizes and structural elements on request



Effective room utilization

Structural Steel Platform System

Our structural steel platforms enable you to expand storage and production areas easily, and utilise previously unused space effectively.

By making use of the workshop's height the available area can be multiplied.

Whether a raised workshop and foreman's office are required, or an additional storage facility, we plan the optimal solution for your room requirement according to your wishes.



SSB – Structural Steel Platform System

An intelligent system with many advantages:

»The structural steel platform was assembled for us quickly and smoothly. Now at last we have some space again in our warehouse.«

Structural steel platforms are the cheapest solution for creating additional space in the production, warehouse and sales areas.

Unlimited possibilities for creating extra storage levels, production areas or sub-constructions for room systems using modular structural steel elements.

Some of the benefits of our structural steel platforms are the high degree of flexibility and the high load-bearing capacity.

- Optimal use of existing room heights
- Creation of additional storage areas without complex construction or renovation
- Tailor-made solution for your individual requirements and spatial conditions
- Structural analysis guarantees maximum security (calculations are available on request)
- Flexible and wide spans available (avoids too many supports)
- Can be combined with our partition walls
- Easy to implement and adapt
- Sustainable through reusability and recyclability



The platforms can be combined with our partition wall systems



Storage platform with integrated shelving system

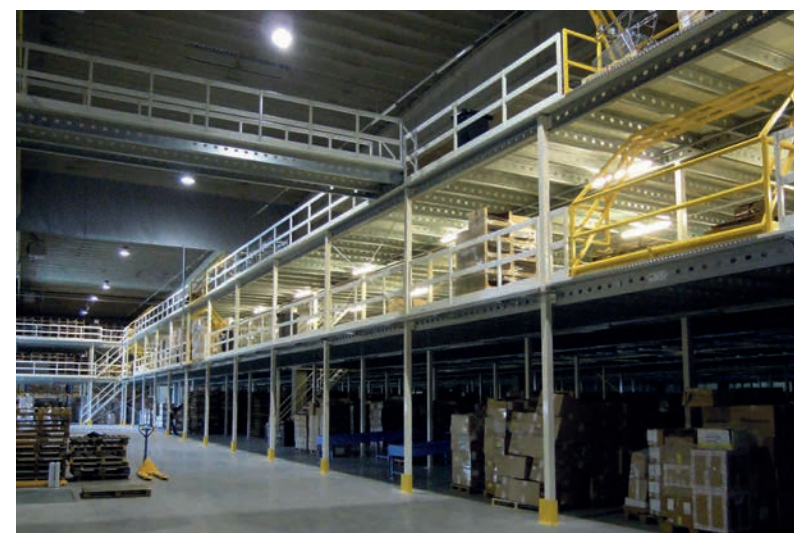

Two-storey storage platform

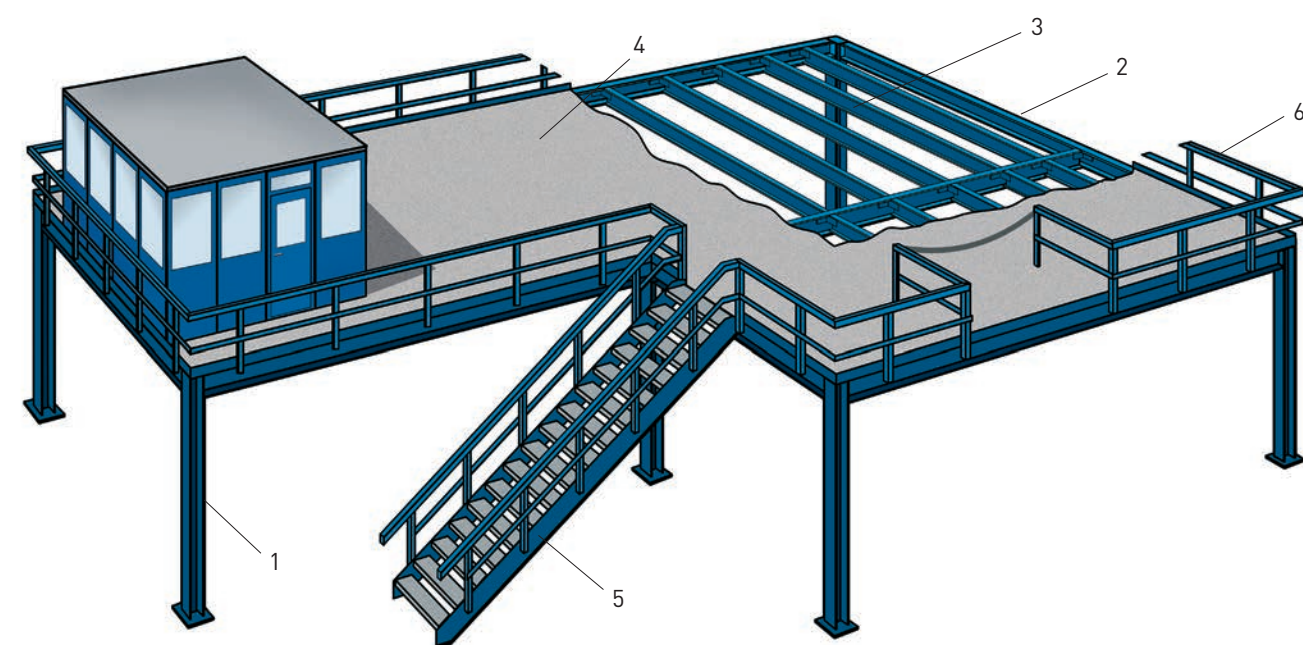

Construction

1. Supports
Made of hot-rolled steel or square tubes

2. Crossbars and 3. Purlins
Made of hot-rolled or cold-rolled steel (size and dimensions depending on the required load and support grid)

4. Covering
Chipboard V 20 (38 mm thick) both sides untreated
Option: with white bottom section or high-strength chipboard with anti-slip coating

5. Stairway
Optionally with steps made of grating or checker plate

6. Railing
Made of square tubes

Surface
Primed and coated with two-component paint
Option: hot-dip galvanized

Floor Coverings

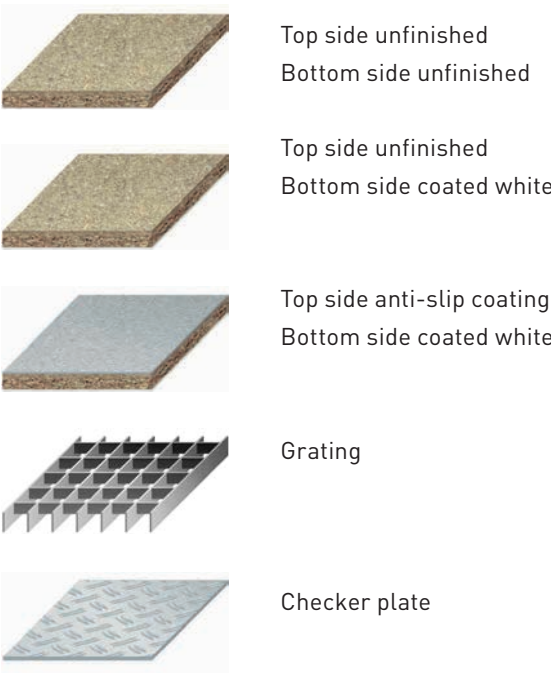

Top side unfinished
Bottom side unfinished

Top side unfinished
Bottom side coated white

Top side anti-slip coating
Bottom side coated white

Grating

Checker plate



Structural steel platform with walkway



Storage platform with pallet loading station and safety chain



Storage platform with rocker and safety gate

Door and Gate Area



Door closer



Door stop/
door catch



Ventilation slide/
ventilation screen



Roller door /
sectional door



Swing door /
fast-action door

Electrical Installation



Wall convector
2 or 2.5 kW



Air conditioner



Surface-mounted
lighting trays



LED Square-edge
panel

Window Area



Sliding window



Turn/tilt window



Interior ledge



Toughened glazing/
laminated glazing

Floor covering / Floor Construction



PVC floor covering,
2 mm thick,
finished,
modern silver grey



PVC floor covering,
2 mm thick,
finished,
moda anthracite



Needle felt floor

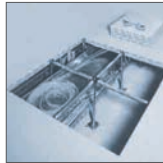

False floor

Sanitary Installation



Wash basin



5L under-table unit



Urinal



WC



Shower cabin

Sound Insulation Version



Retractable
bottom seal in
the door



Glass window 8 mm
toughened safety
glass in the door



Ceiling with mineral
wool insulation
(40 mm thick)

How many walls do I need?



4-sided
room solution



3-sided
room solution



2-sided
room solution



1-sided
room solution

Construction Options



1-storey room
solution



Room solution under a
structural steel platform



2-storey room
solution



Room solution on top of a
structural steel platform



PREMIUM QUALITY

MADE IN GERMANY

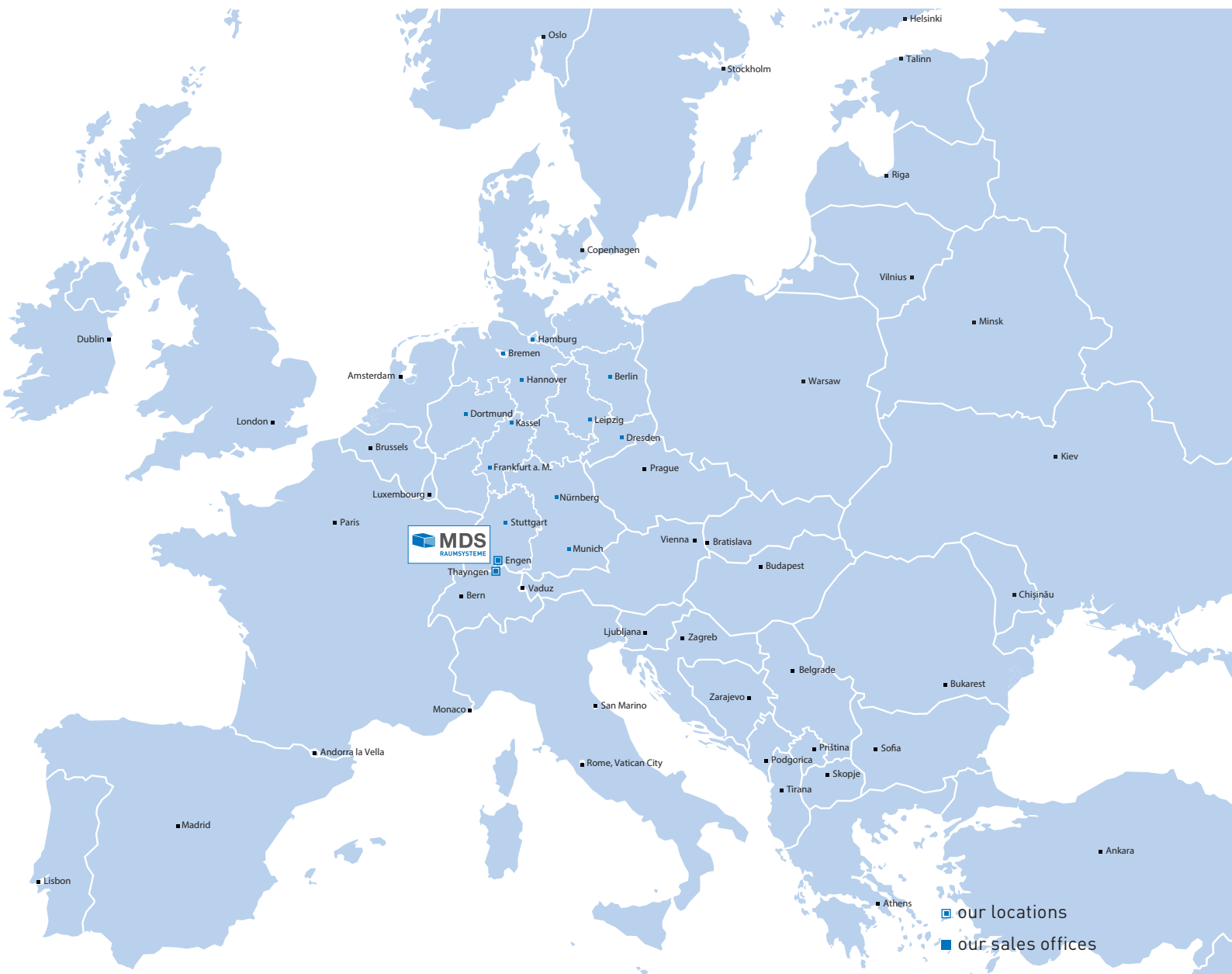

We create rooms for Europe
and are close at hand - wherever you are

MDS Raumsysteme GmbH

Otto-Hahn-Straße 4
78234 Engen-Welschingen, Germany

Phone +49 7733 9489-3
Fax +49 7733 9489-50

info@mds-raumsysteme.com
www.mds-raumsysteme.com